

Protection Foot

In harsh store environments, where shopping trolleys are in use, antennas can get damaged when these trolleys collide with the antennas. For those environments, the Protection Foot can be used to prevent damage to the antenna and to ensure proper functioning of the complete system.

The full Protection Foot consists of three parts; two protection poles, available in 300 mm and 600 mm height, and an optional trolley guide that is slit over these poles and protects the body of the antenna.

The trolley guide can easily be removed to maximize the entrance width in case large objects need to pass, for example during delivery of store stock, as well as during maintenance of the antenna.

The trolley guides can be used in combination with SOLUS, FORTUS, NEXUS and MODUS systems.

Unique features

Solid and durable antenna protection solution

Made of brushed stainless steel

Easy and quick mounting

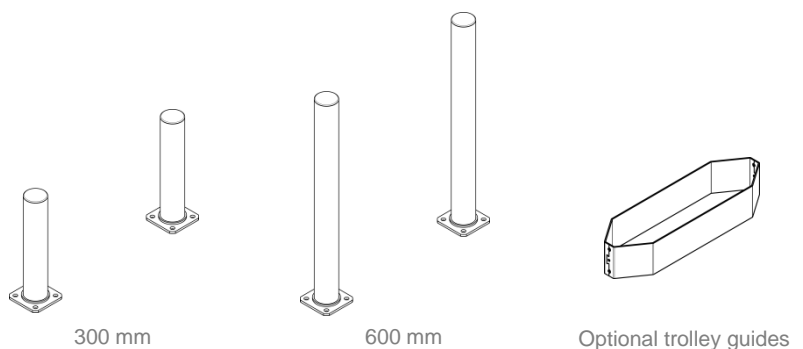

Protection Foot

PROTECTION POLES

300 mm height

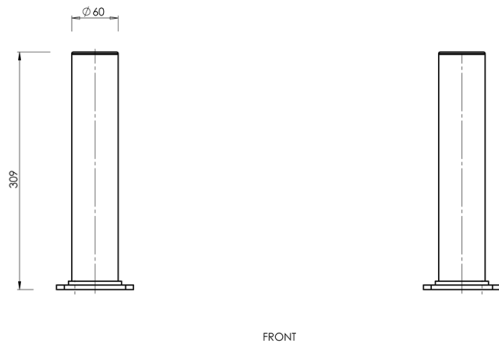
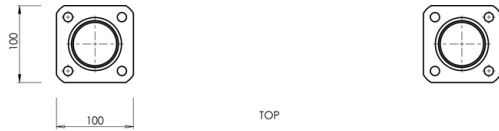

600 mm height

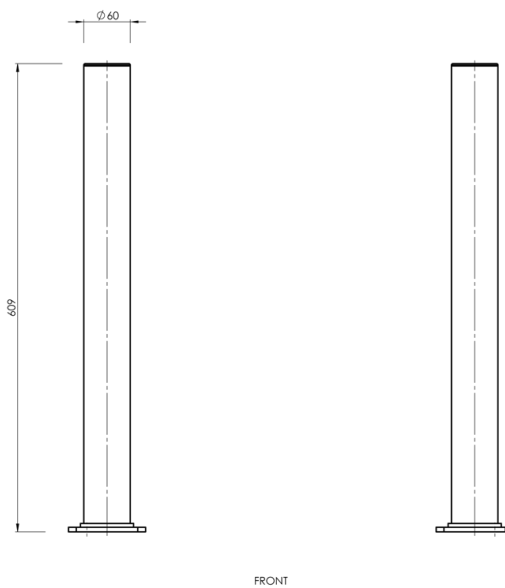
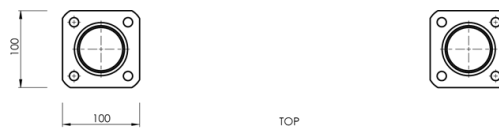

TROLLEY GUIDES

for MODUS and NEXUS

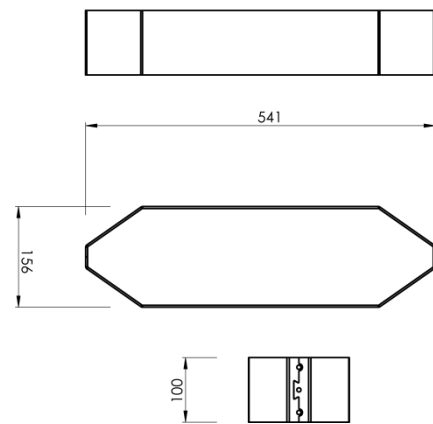
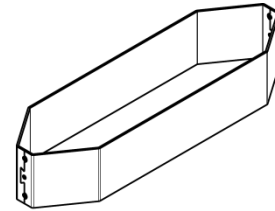

for FORTUS and SOLUS

